

4009

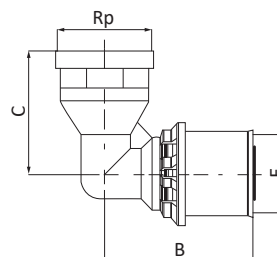

Gomito a 90° con derivazione femmina - 90° elbow with threaded female take off - Coude à 90° avec dérivation femelle - Codo 90° con salida rosca hembra - Winkel 90° mit Innengewinde - Колено 90° с внутренней резьбой



DIM [mmxin.]	CODE	DIM MAX LxHxP [mm]	B [mm]	C [mm]	E [mm]	Rp [in.]	PACK	
							BAG [UMV]	OT1
16x1/2"	4009160002001	56x42x27	43	31	16x2,0	1/2" (1)	5	30
18x1/2"	4009180002001	56x44x27	43	32	18x2,0	1/2" (1)	5	30
20x1/2"	4009200002001	57x46x28	44	33	20x2,0	1/2" (1)	5	30
20x3/4"	4009200003001	61x52x31	46	39	20x2,0	3/4" (1)	5	25
26x3/4"	4009260003001	62x56x35	47	39	26x3,0	3/4" (1)	5	20
26x1"	4009260004001	74x64x43	50	48	26x3,0	1" (1)	5	10
32x1"	4009320004001	78x67x43	57	47	32x3,0	1" (1)	5	10
40x1"1/4	4009400005001	98x80x53	72	56	40x3,5	1"1/4 (2)	1	6
50x1"1/2	4009500006001	114x95x59	84	66	50x4,0	1"1/2 (2)	1	3

⁽¹⁾ Filettatura secondo ISO 7/1, EN 10226-1 - Threading according to ISO 7/1, EN 10226-1 - Filetage conformément à la norme ISO 7/1, EN 10226-1 - Roscado según ISO 7/1, EN 10226-1 - Gewinde gemäß ISO 7/1, EN 10226-1 - Резьба согласно ISO 7/1, EN 10226-1

⁽²⁾ Filettatura secondo ISO 228-1 - Threading according to ISO 228-1 - Filetage conformément à la norme ISO 228-1 - Roscado según ISO 228-1 - Gewinde gemäß ISO 228-1 - Резьба согласно ISO 228-1

4011



Gomito a 45° - 45° elbow - Coude à 45° - Codo 45° - Winkel 45° - Колено 45°

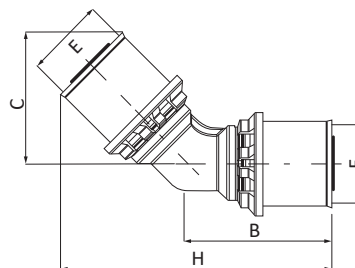

DIM [mm]	CODE	DIM MAX LxHxP [mm]	H [mm]	B [mm]	C [mm]	E [mm]	PACK	
							BAG [UMV]	OT1
26x26	4011260000001	60x88x35	88	46	43	26x3,0	1	-
32x32	4011320000001	65x90x40	90	46	45	32x3,0	1	-
40x40	4011400000001	86x122x53	122	63	60	40x3,5	1	-