

CODE 1008

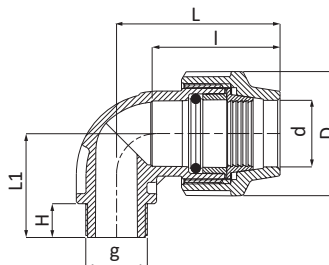

Gomito a 90° con derivazione maschio



CODE	DIM dxg [mmxin.]	D [mm]	I [mm]	H [mm]	L [mm]	L1 [mm]	PN [bar]	PACK	
								RIF. 2	RIF. 5
1008016002001	16x1/2"	42	40	18	54	48	16	80	-
1008016003001	16x3/4"	42	40	19	54	48	16	80	-
1008020002001	20x1/2"	46	46	18	57	39	16	75	350
1008020003001	20x3/4"	46	46	19	57	40	16	75	350
1008025002001	25x1/2"	55	54	18	66	43	16	50	220
1008025003001	25x3/4"	55	54	19	66	44	16	50	220
1008025004001	25x1"	55	54	22	66	47	16	50	200
1008032002001	32x1/2"	63	58	18	78	50	16	30	130
1008032003001	32x3/4"	63	58	19	78	51	16	30	130
1008032004001	32x1"	63	58	22	78	53	16	30	130
1008032005001	32x1"1/4	63	58	25	78	56	16	30	130
1008040004001	40x1"	80	71	22	95	61	16	15	70
1008040005001	40x1"1/4	80	71	25	95	64	16	15	70
1008040006001	40x1"1/2	80	71	25	95	64	16	15	70

>>>

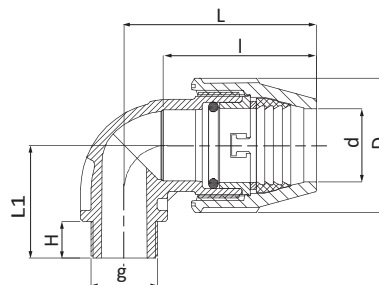

>>>

CODE	DIM dxg [mmxin.]	D [mm]	I [mm]	H [mm]	L [mm]	L1 [mm]	PN [bar]	PACK	
								RIF. 2	RIF. 5
1008051005001	50x1"1/4	96	103	27	130	77	16	-	36
1008051006001	50x1"1/2	96	103	27	130	77	16	-	36
1008051007001	50x2"	96	103	27	130	77	16	-	36
1008064006001	63x1"1/2	115	130	23	160	85	16	-	20
1008064007001	63x2"	115	130	28	160	100	16	-	20
1008064008001	63x2"1/2	115	130	32	160	104	16	-	20
1008076007001	75x2"	129	130	28	180	100	16	-	14
1008076008001	75x2"1/2	129	143	32	180	104	16	-	13
1008076009001	75x3"	129	143	35	180	107	16	-	13
1008091009001	90x3"	155	158	35	200	114	16	-	7
1008091010001	90x4"	155	158	41	200	120	16	-	7
1008111010001	110x4"	183	211	42	265	144	16	-	4