

CODE 1003

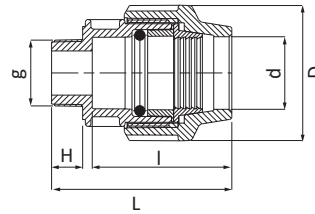

Raccordo maschio



CODE	DIM dxg [mmxin.]	D [mm]	L [mm]	I [mm]	H [mm]	PN [bar]	PACK	
							RIF. 2	RIF. 5
1003016001001	16x3/8"	42	69	50	13	16	140	-
1003016002001	16x1/2"	42	69	50	16	16	140	-
1003016003001	16x3/4"	42	69	50	17	16	140	-
1003020002001	20x1/2"	46	81	61	16	16	80	380
1003020003001	20x3/4"	46	82	61	17	16	80	380
1003020004001	20x1"	46	85	61	20	16	80	380
1003025002001	25x1/2"	55	89	69	16	16	50	240
1003025003001	25x3/4"	55	90	69	17	16	50	240
1003025004001	25x1"	55	93	69	20	16	50	220
1003032002001	32x1/2"	63	98	76	16	16	30	160
1003032003001	32x3/4"	63	98	76	17	16	30	160
1003032004001	32x1"	63	101	76	20	16	30	160
1003032005001	32x1"1/4	63	104	76	23	16	30	150
1003032006001	32x1"1/2	63	104	76	23	16	30	140
1003040004001	40x1"	80	108	82	21	16	20	90
1003040005001	40x1"1/4	80	117	82	29	16	20	85
1003040006001	40x1"1/2	80	117	82	28	16	20	85
1003040007001	40x2"	80	120	82	34	16	20	85

>>>

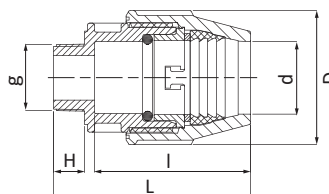

>>>

CODE	DIM dxg [mmxin.]	D [mm]	L [mm]	I [mm]	H [mm]	PN [bar]	PACK	
							RIF. 2	RIF. 5
1003051004001	50x1"	96	128	99	23	16	-	45
1003051005001	50x1"1/4	96	133	99	28	16	-	45
1003051006001	50x1"1/2	96	133	99	28	16	-	45
1003051007001	50x2"	96	137	99	32	16	-	45
1003064005001	63x1"1/4	115	157	120	28	16	-	28
1003064006001	63x1"1/2	115	157	120	28	16	-	28
1003064007001	63x2"	115	161	120	32	16	-	28
1003064008001	63x2"1/2	115	158	120	29	16	-	25
1003076007001	75x2"	129	171	135	27	16	-	18
1003076008001	75x2"1/2	129	178	135	34	16	-	18
1003076009001	75x3"	129	178	135	34	16	-	18
1003091007001	90x2"	155	200	158	34	16	-	10
1003091008001	90x2"1/2	155	200	158	34	16	-	10
1003091009001	90x3"	155	200	158	34	16	-	10
1003091010001	90x4"	155	200	158	36	16	-	10
1003111007001	110x2"	183	247	198	34	16	-	6
1003111009001	110x3"	183	250	198	37	16	-	6
1003111010001	110x4"	183	250	200	37	16	-	6