

CODE 4007

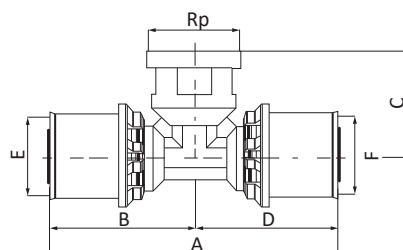

Ti a 90° con derivazione femmina



CODE	DIM [mmxin.]	A [mm]	B [mm]	C [mm]	D [mm]	E [mm]	F [mm]	Rp [in.]	BAG [UMV]	BOX
4007160002001	16x16x1/2"	91	46	32	46	16x2,0	16x2,0	1/2" ⁽¹⁾	2	20
4007180002001	18x18x1/2"	91	46	32	46	18x2,0	18x2,0	1/2" ⁽¹⁾	2	16
4007200002001	20x20x1/2"	92	46	32	46	20x2,0	20x2,0	1/2" ⁽¹⁾	2	16
4007200003001	20x20x3/4"	101	46	34	46	20x2,0	20x2,0	3/4" ⁽¹⁾	2	16
4007260003001	26x26x3/4"	93	46	37	46	26x3,0	26x3,0	3/4" ⁽¹⁾	2	12
4007320004001	32x32x1"	116	58	42,5	58	32x3,0	32x3,0	1" ⁽¹⁾	2	8
4007400005001	40x40x1"1/4	152	76	49	76	40x3,5	40x3,5	1"1/4" ⁽²⁾	1	12
4007500006001	50x50x1"1/2	162	84	49	84	50x4,0	50x4,0	1"1/2" ⁽²⁾	1	12
4007630005001	63x63x1"1/4	170	85	43	85	63x4,5	63x4,5	1"1/4" ⁽²⁾	1	8

⁽¹⁾ Filettatura secondo ISO 7/1, EN 10226-1

⁽²⁾ Filettatura secondo ISO 228-1